



User Manual

Sonic Vibration Solar Toothbrush

SOLADEY
RHYTHM 2
SOLADEY RHYTHM 2

Product **AE-22C**

Thank you very much for purchasing our product. This user manual contains important notes on using it safely and properly, so please be sure to read it.

Battery Used: 1 x AAA alkaline battery
*Batteries sold separately

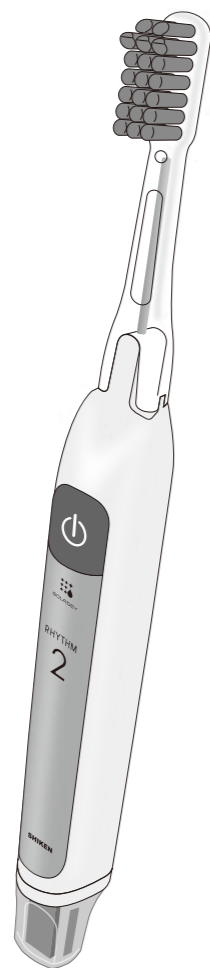

Part Names

Please ensure that all of the following items are included when opening the package.

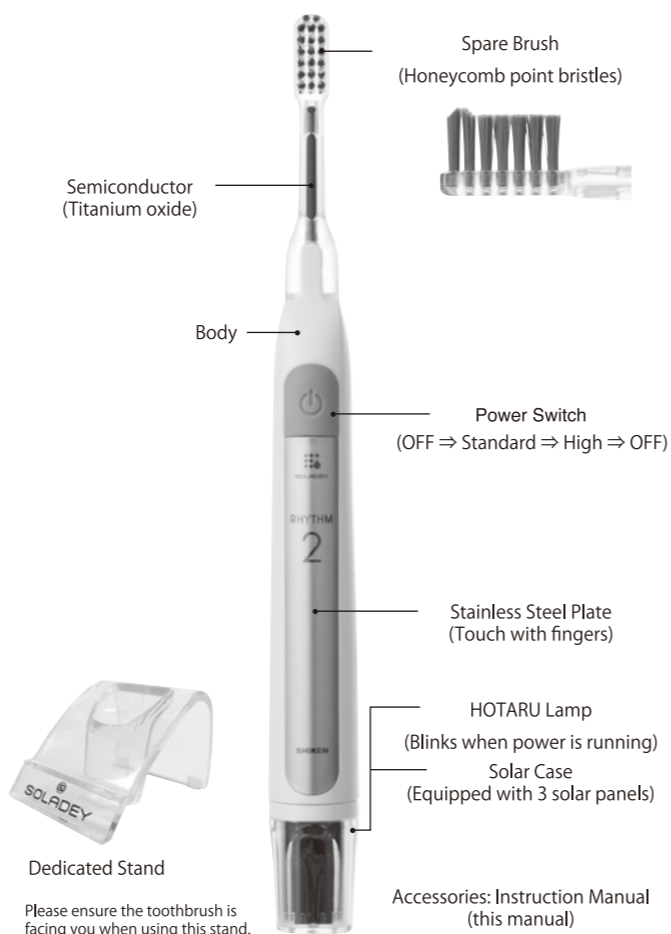

Safety Precautions

<Please read this before use>

The contents presented here are intended to enable you to use this product safely and correctly, and to prevent personal injury or property damage. The severity of injuries or damage caused by incorrect use are categorized and explained below.

- Danger** Indicates a high risk of injury or death.
 - Warning** Indicates a risk of injury or death due to improper use.
 - Caution** Indicates possible minor injury or physical damage.
- The safety precautions to observe are described via the symbols below.**
- Prohibited actions.
 - Indicates mandatory actions (always observe)

- Danger**
- Do not use in close proximity to electrical medical devices or home electrotherapy equipment such as pacemakers or defibrillators. (This causes dangerous malfunctions or ill health.)

Warnings

- Please store the main unit and replacement brushes out of the reach of small children, and do not allow them to use this product. (This will prevent accidental swallowing or injury.)
- Consult a dentist if you experience any unusual symptoms in your mouth. (This may cause wounds to worsen.)
- Do not use while pregnant or within 1 month of giving birth. (This may cause accidents or ill health.)
- Do not use or store in the bathroom. (This may lead to short circuits or electric shock.)
- Do not use deteriorated or expired dry batteries. (This may lead to damage to the product.)

Precautions

- Follow the precautions of the specified battery, and insert it with the + and - ends aligned properly.
- If the battery is dead, remove it as soon as possible.
- Remove the battery if you will not use it for an extended time.
- Make sure the main unit is not wet when replacing the battery.
- Do not use the main unit without a brush attached.
- Do not use it for any purpose other than brushing teeth.
- Do not use it if you are not able to perceive your own actions.
- Do not drop or step on the main unit, or expose it to strong impacts.
- Disassembly, modification, and repair are prohibited.
- Do not use toothpaste containing a large amount of abrasives.
- Washing or drying in a dishwasher, dish dryer, or microwave oven, etc., is prohibited.
- Do not immerse the main unit in water.
- Do not share a brush among multiple people.

Requests Please do not rub the button switches with your fingers. Please do not press the button switches with your fingernails or sharp objects. After brushing your teeth with saltwater, please wipe away any moisture left on the main unit.

Product Specifications

<Main Unit>

Weight	about 50g (with brush, no battery)
Outer Dimensions	221mm long x 22.6mm max. diameter
Battery Used	1 x AAA alkaline battery
Battery Life	2 min. per use, about 120 uses (240 min.)

*Product specifications may change without advance notice.

<Brush> (Honeycomb Bristles)

Handle Material	Acrylic resin
Bristle Material	Nylon
Bristle Stiffness	Medium
Max. Temperature	60°C

Eco-friendly Design

The use of low power circuitry reduces battery consumption and loss of motor speed.

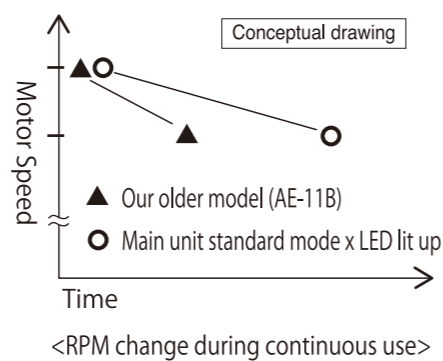

Soladey's Chemical Effects

The Soladey Rhythm 2 is a sonic solar toothbrush combining a semiconductor (titanium dioxide) and a solar cell. The semiconductor reacts to light and water while the solar panel reacts to light, and both sources produce e- electrons. The two e- electrons display effective plaque-cleaning power.

Light from the sun and electricity (clean energy)

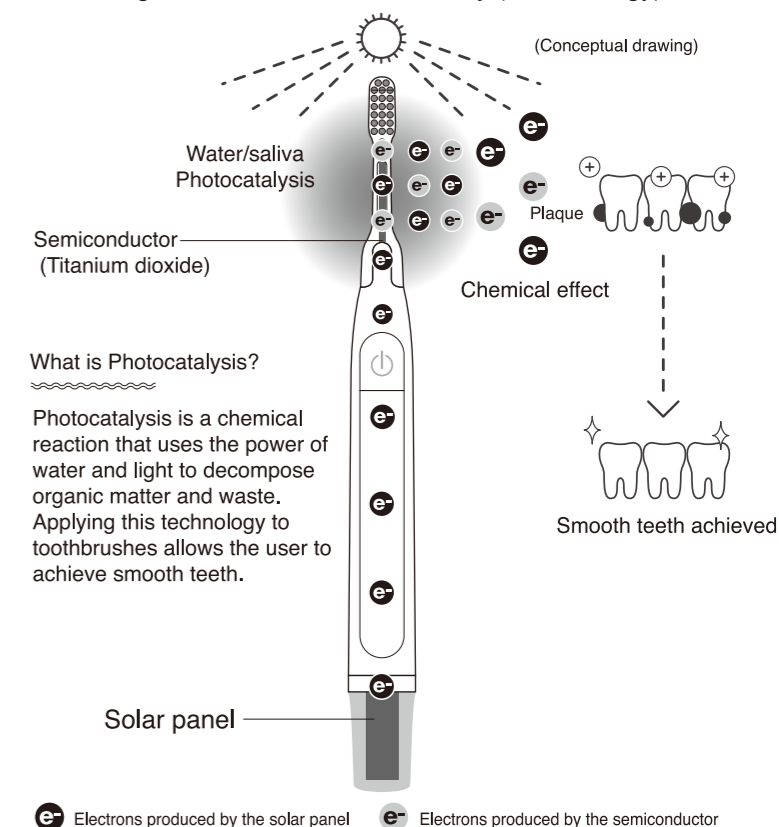

e- Electrons produced by the solar panel e- Electrons produced by the semiconductor

How to Replace the Brush

Removal

Rest the brush and main unit horizontally, then pull the brush out in a straight motion. Failure to pull the brush out in a straight motion may result in the bending of the semiconductor (titanium dioxide rod).

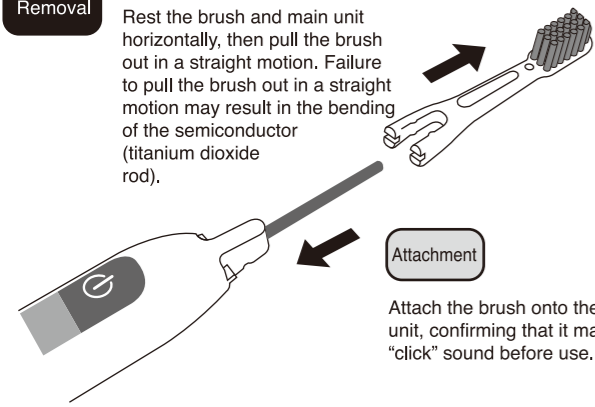

Attachment

Attach the brush onto the main unit, confirming that it makes a "click" sound before use.

If you are having difficulty attaching or removing the brush, then it may be dirty with toothpaste or other residue. In this case, soak the brush in warm water for 5 minutes to loosen residue, and then wipe it off.

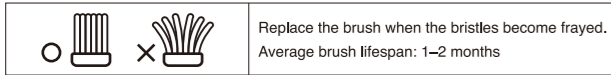

A frayed brush will lose cleaning ability due to lowered resilience and contact area.

Replacing Batteries



Batteries may pop out with unexpected force, so please rest the unit horizontally before proceeding to Step (1).

- 1 Twist the solar case in the direction of the arrow to remove it.

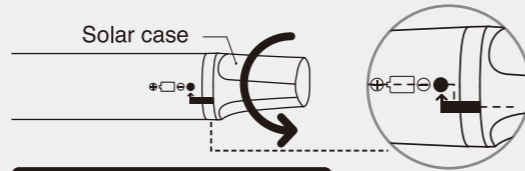

- 2 Insert AAA alkaline battery.

*Note the direction of the ⊕ ⊖ signs.



- 3 Twist the solar case in the direction of the arrow to close the compartment.

*As seen in the image, twist the solar case until the ● and ■ are lined up in a straight line.

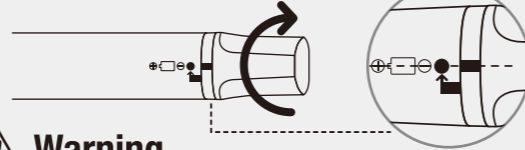

Warning

- Only use AAA alkaline batteries with this toothbrush.
- Be careful not to let water get inside of the unit when replacing the battery.
- Do not remove the waterproof packing.
- Replace batteries only after turning the unit OFF.
- The solar cell is unable to charge the AAA battery or work the vibration motor. Replace the alkaline battery when it runs out.
- It is normal for the HOTARU lamp to blink even when the alkaline battery is drained to the point that the vibration motor no longer runs.

Functions

2 Vibration Modes

Press the button once to switch between modes.

Vibration changes in the order of OFF⇒Standard Mode⇒Power Mode⇒OFF.

Standard Mode	18,000 brush strokes per minute
Power Mode	22,000 brush strokes per minute.



This Soladey toothbrush is powered by a Mabuchi Motor, known for quality and durability.

HOTARU Lamp

When the e- electrons produced by the solar panel and semiconductor are sent into your oral cavity, the solar case's LED lamp will blink like a firefly to indicate that electrons are being supplied.

*The LED lamp is powered by the alkaline battery.

*Wet the brush thoroughly before use.

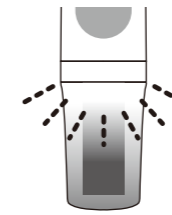

How to Use

1 Attach the brush.

Brush is equipped with hexagon-shaped cross section resilient bristles + point-shaped tips for reaching back teeth and into gaps.



2 Wet the entire brush thoroughly.

Wet the water hole and bristle tips of the brush.

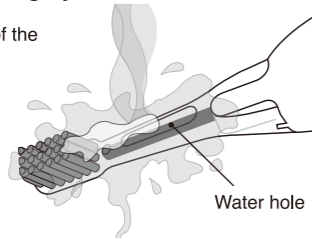

*When using toothpaste, use only a small amount (From the size of a grain of rice to an adzuki bean is recommended).

3 Place brush inside of oral cavity and press the switch *1.

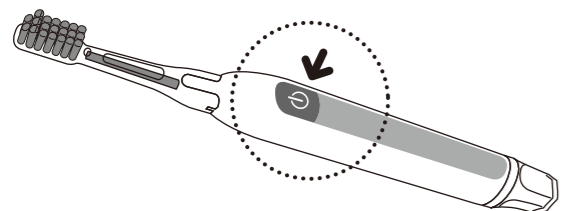

*1 Prevents the scattering of liquid and toothpaste from vibration.

*Mode switches in the order of OFF►Standard►Strong.

4 Brush teeth

Hold the main unit so that your fingers rest on the frontal stainless plate, and brush your teeth only in a bright room, such as the bathroom. You can check the LED lamp by brushing in front of a mirror.

*The reactivity increases when using the brush with wet fingers.

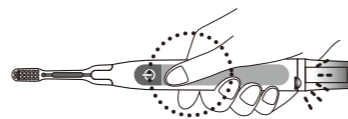

[About the HOTARU Lamp]

*When brushing, make sure that your lips or inside of your cheeks are touching the brush's resin portion.

*It is normal for the blinking of the lamp to become irregular when brushing your front teeth.

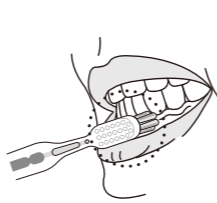

5 Turn the unit OFF

When using Standard Mode:

... Press button twice ►OFF

When using Power Mode:

... Press button once ►OFF

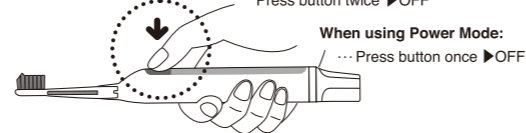

The blinking of the HOTARU lamp may become irregular depending on your brushing environment. You can detect any electric current abnormalities by following these steps.

1.Prepare the main unit by putting in a AAA alkaline battery.

2.Remove the brush, and hold the unit by the "semiconductor" and "stainless plate" (See right).

3.Confirm that the solar panel blinks slowly.

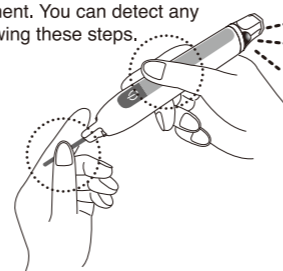

Effective Usage

Slowly brush your teeth one by one, using only enough pressure that the brush touches your teeth gently. We recommend brushing your teeth for 2 minutes, twice per day.

3 Tips for Effective Brushing

1 Start with the hard-to-reach spots.

[Between teeth and gums] Angle the brush at a 45° angle, and brush using short motions as to wedge the bristles between your teeth and gums.

[Between teeth] Your back teeth can be brushed by using the top corners of the toothbrush. Use the top and bottom corners to brush the back of your front teeth.

[Occlusion] Use the top corners of your toothbrush to brush your occlusion.

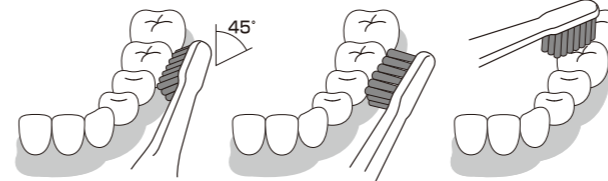

2 Brush in front of a mirror.

Make sure that your toothbrush's bristles are touching your teeth. There are significant individual differences between the sizes and shapes of different people's teeth, so confirming where the bristles are making contact as you brush is important. Brush your teeth in front of a mirror, as you would do for your facial care routine.

3 Pay attention to brushing pressure.

Not only will brushing with too much pressure not give you a good clean, but it will also cause damage to your teeth and gums.

Maintenance/Storage

1 Washing the brush

Remove the brush after use, rinse it, shake off excess water, reattach it to the main unit, and store it in a well ventilated area.



2 Washing the main unit

Wash the main unit in water when you find that it is dirty. To clean off residue from toothpaste on the semiconductor (titanium dioxide), wash it after removing the brush and thoroughly dry it off (Once a week).

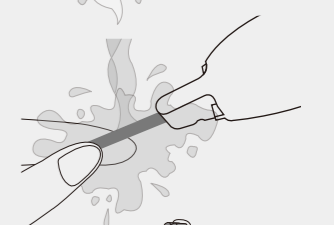

*Please do not use boiling water, chlorine bleach, alcohol, thinner, nail polish remover, or any other organic solvents, as they may cause the resin to deteriorate.

*It is normal for the HOTARU lamp to blink when cleaning the main unit.

3 Storage

After washing, thoroughly dry off the toothbrush with a towel, place it onto its stand, and store it in a well ventilated area.

